

USB 2.0 PTZ 10X CAMERA Quick Start Guide

1 Appearance and Connections

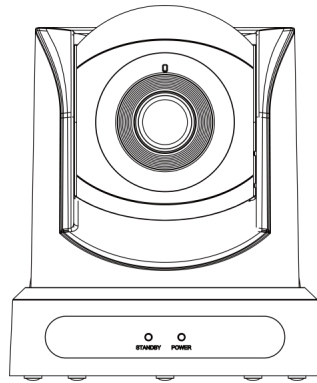

2 Packing List

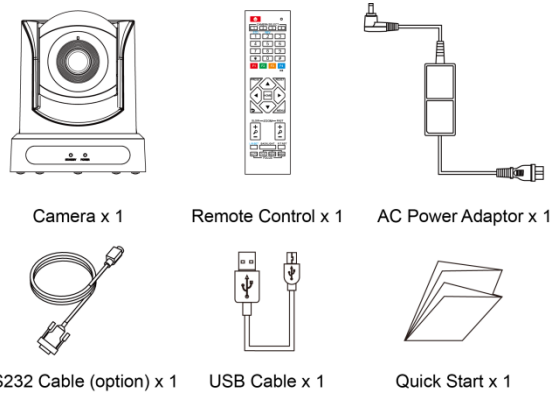

3 Remote Control

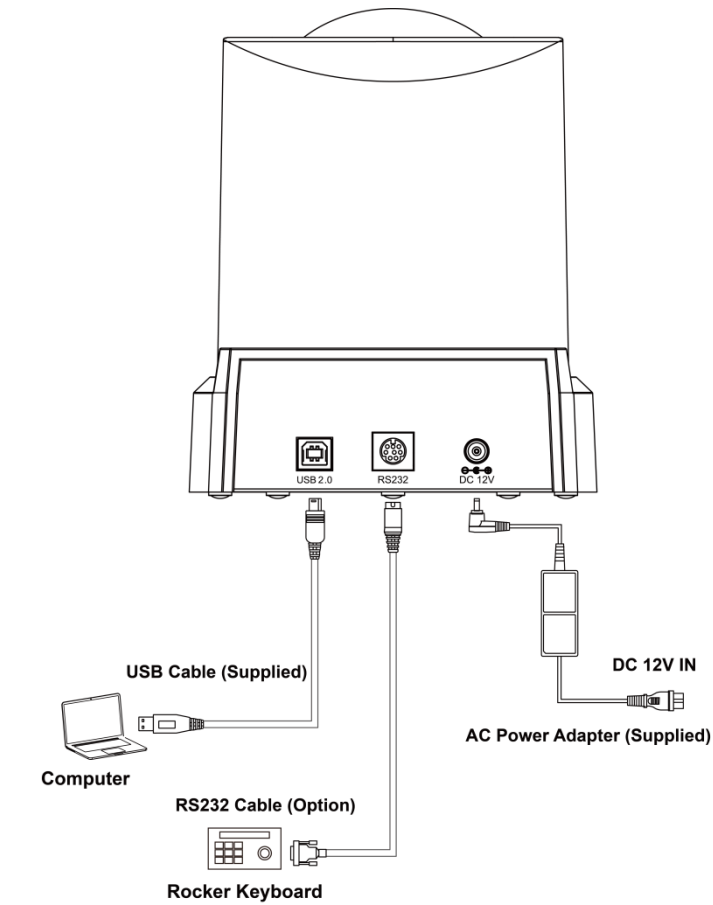
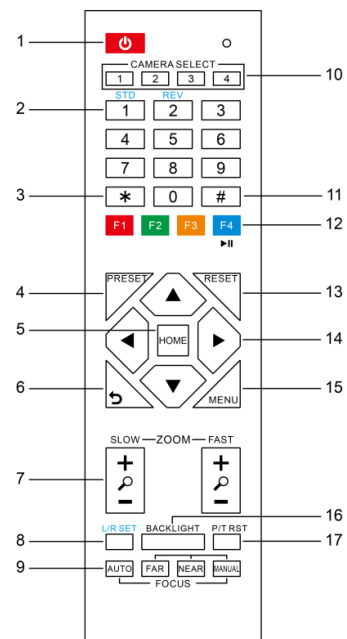

No.	Name	Function Description
1	Standby Key	Enter into standby
2	Number Key	Preset setting or transfer preset
3	*Key	Use in conjunction with another key/function
4	Preset Key	Preset: Setting Preset + Number key (0-9)
5	HOME Key	Returns PTZ back to the middle position
6	Return Key	Return back the last level menu
7	Zoom Button	Adjust lens wide angle/narrow angle slowly or quickly
8	Left/Right Setting Key	<ul style="list-style-type: none"> Standard: Simultaneously press Left/Right setting key + 1 (horizontal) Reverse: Simultaneously press Left/Right setting key + 2 (horizontal)
9	Focus Key	auto/manual/far-end/near-end focus
10	Selection Key	Select which camera to control
11	#Key	Use in conjunction with another key/function
12	IR Remote Control Key	[*+ # +F1/F2/F3/F4]: NO.1/2/3/4 address
13	Reset Key	Delete preset (reset key + corresponding preset number key)
14	PTZ Control key	PTZ adjustments when not in OSD
15	Menu Key	Enter or exit OSD Menu after pressed it
16	Backlight Key	Turn on/off backlight consumption (loop)
17	PTZ Reset Key	Reset PTZ

4 Presets

To Create a Preset

Set the camera to your desired view. Press the PRESET button, then press any one of the 10 (0-9) numeric buttons. The on-screen display will confirm the preset is saved.

To Call a Preset

Press any numeric button (0-9) to call a preset.

5 On-Screen Menu

Press the MENU button to enter the on-screen menu:

- Exposure
- PTZ
- Setup
- Restore Default
- Image
- Noise Reduction
- Communication Set

6 Product Features

Full-Featured USB Interface

USB 2.0 interface, support encoding output, and support UVC 1.0 protocol.

Full HD – 1080p

High-quality HD CMOS sensor with 2.07 million effective pixels for hi-def images up to 1920x1080 resolutions.

Low Light

2D and 3D noise reduction technology greatly reduces the image noise and maintains a clear image under low lighting conditions with a signal-to-noise-ratio (SNR) of 55dB (max).

H.264 Slice/SVC Encoding

Output H.264 code stream, and support Slice and SVC encoding mode, can adapt to high-end USB video conferencing applications.

Double Stream

Supports two code streams/simultaneous output (YUY2, MJPEG, H.264 any two), can reduce the host codec pressure.

Remote Control

This camera can be remotely controlled via RS232.

7 RS232 Interface

Interface diagram	No.	Function	No.	Function
	1	DTR	5	RXD
	2	DSR	6	GND
	3	TXD	7	IR OUT
	4	GND	8	NC

8 Safety Precautions

Electrical Safety

The installation and use of this product must strictly comply with local electrical safety standards.

Power Polarity

This product uses DC +12V power supply (max current 2A). Please pay attention to the polarity of power supply.

Operation

Hold camera base when moving the unit. Do not rotate camera head by hand. It may cause mechanical problems.

Disassembly

Do not disassemble the camera. Damage caused by the user's own disassembly is not covered by the warranty.



- Electromagnetic fields at specific frequencies may affect the image of the machine.
- Do not hot-plug the power supply during the use of the IP Camera.

9 Troubleshooting

Image

No image on screen

- Check that the camera power supply is connected, the voltage is normal, and the power indicator light is always on.
- Turn off the power switch to check whether the camera is self-testing.
- Check the cable of video platform and TV whether correct connection.

Image appears intermittently

Check video cables for secure connection.

Control

IR remote does not control

- Check and replace the battery for the remote.
- Check whether the camera's working mode is correct.
- Check whether the address of remote control matches the camera.

RS232 port does not control

- Check whether the camera protocol/address is the same.
- Check whether the control line is connected securely.



PureLink™
22-10 State Route 208
Fair Lawn, NJ 07410 USA
Tel: +1.201.488.3232
Fax: +1.201.621.6118
E-mail: sales@purelinkav.com

For order support, please contact your local dealer.
For technical support, please contact us at support@purelinkav.com.